

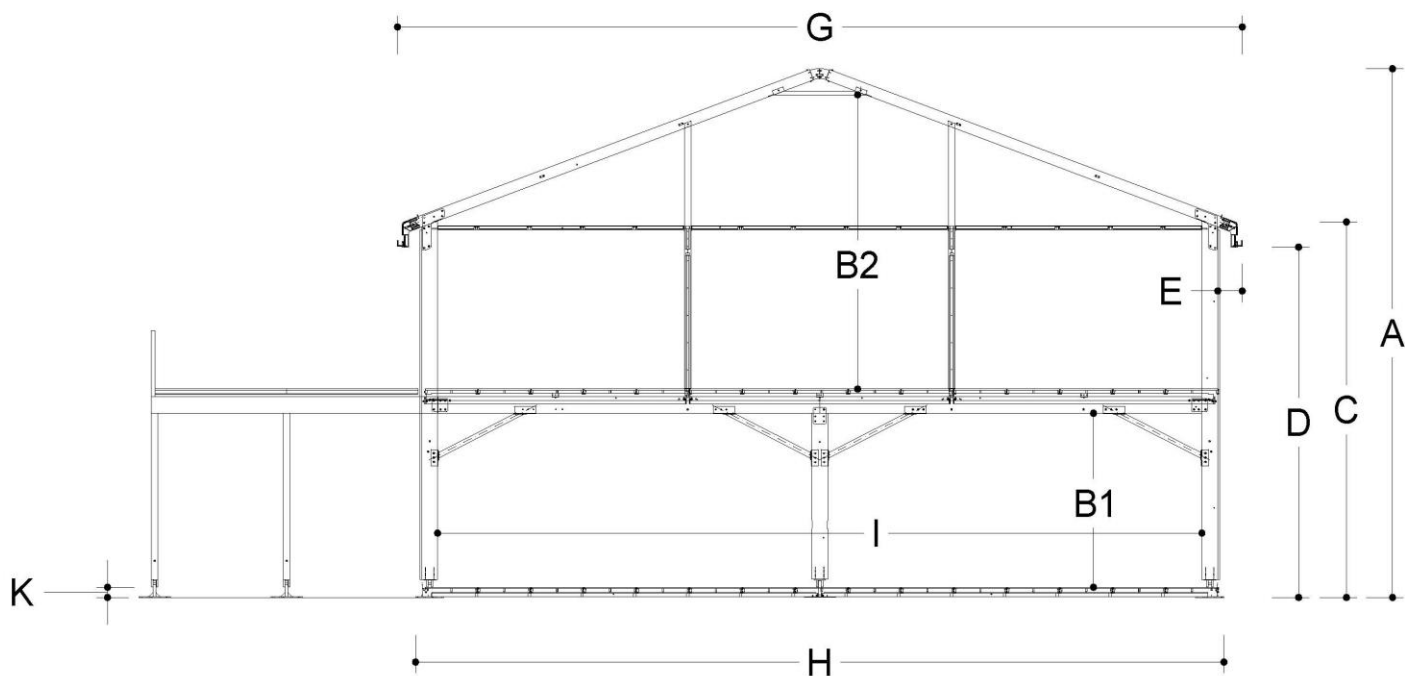

# President

# D15/680/5



## Technical data

	(mm)			
A	External ridge height	9756	Wind load	0,50 kN/m <sup>2</sup>
B1	Internal free height ground floor	3300	Snow load	0 KN/m <sup>2</sup>
B2	Internal free height first floor	5490	Bearing capacity standard floor	500kg/m <sup>2</sup>
C	External side height	6870	Column profile	120x300
D	External free height	6430	Maximum roof load	400kg per rafterset
E	Roof overhang	340	Mounting points in structure	Columns and rafters
G	External width of the roof	15820	Roof incline	20°
H	Maximum width ground level	15375	Standard fire resistance standard roof covers	DIN 4102/B1 M2 B-s2,d0
I	Internal width between columns	7087		
J	Bay distance	5000		
K	Floorheight	183		



# President

# D15/680/5

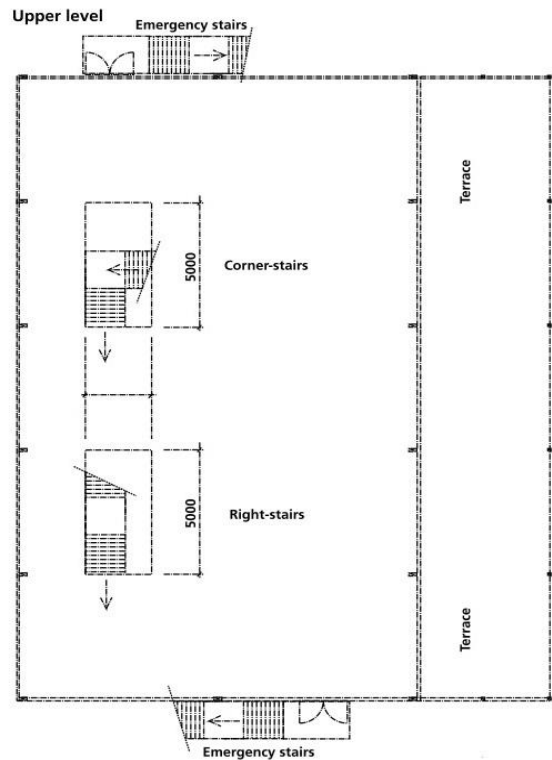
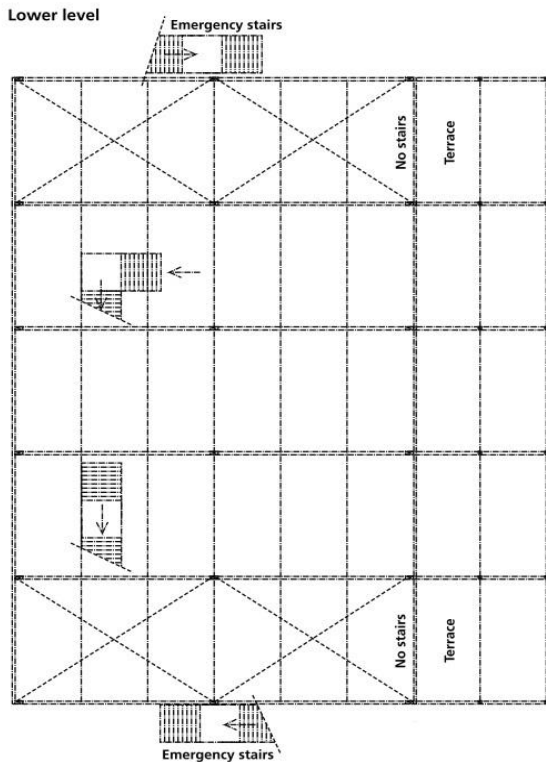

## Options

- Available roof covers
  - White opaque roof cover (bovenverdieping)
  - Transparent roof cover (bovenverdieping)
- Available floors
  - Cassette floor
  - Plate floor
  - Antiskid cassette floor
- Available doors
  - Aluminium push bar door 2m (blind)
  - Aluminium push bar door 2m (glass)
  - Emergency door

- Available side curtains and side panels
  - PVC side curtains with arched windows
  - Vertical PVC side panels
  - Vertical glass side panels
- Insulation side panels
  - No
- Connection to permanent buildings
  - Yes
- Connection to other Losberger De Boer structures
  - Yes